



## GRUNDFOS DMX Mechanical Pumps

DMX range offers reliable, tough and well-proven dosing. With a robust diaphragm-based design and high-quality motors, DMX pumps require minimum maintenance and are best choice for many dosing applications. The DMX range is highly versatile: it covers a wide flow range and offers a variety of dosing head sizes, materials and accessories.

### Features

- Robust industrial pump with chemical resistance plastic enclosure
- Easy to install and operate design
- Long life PTFE coated diaphragm
- Optimum capacity and stroke frequency graduation
- Robust design
- Stroke-length adjustment
- Dosing flow variation  $\pm 1.5\%$  (FS), linearity  $\pm 4\%$  (FS)

### Applications

- Food and beverage industry
- Drinking water treatment
- Wastewater treatment
- Pulp and paper industry
- Textile industry
- Irrigation
- Agriculture



### Dimensions

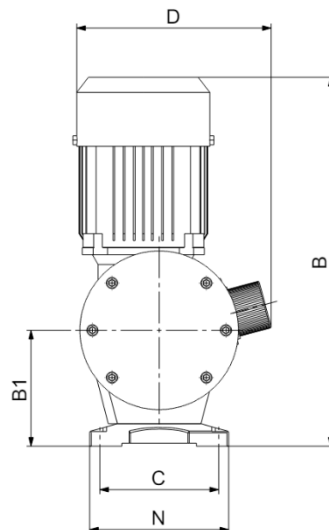
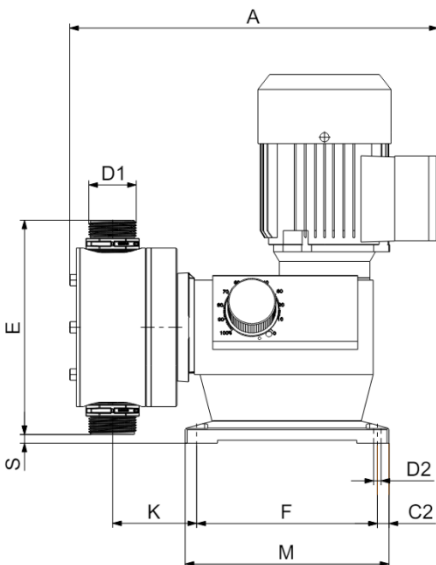

DMX	16-12	35-10	50-10
A (mm)	275		
B (mm)	319		
B1 (mm)	102.5		
C (mm)	105		
C2 (mm)	10.5		
D (mm)	175		
D1	G 5/8		
D2 (mm)	6.5		
E (mm)	153		
F (mm)	159		
K (mm)	32		
M (mm)	180		
N (mm)	123		
S (mm)	26		



## Technical Specifications

Mechanical Data	DMX	16-12	35-10	50-10
Nominal dosing flow (L/h)		16	35	50
Max. counterpressure (bar)		12	10	10
Connection inlet/outlet		DN 8		
Stroke frequency at 50 Hz (n/min)		120		
Max. pump stroke volume (mL)		2.2	4.9	6.9
Max. suction lift (m)		4	3	3
Max. suction lift with max. viscosity (m)		1		
Max. length of inlet line (m)		5	4	4
Max. viscosity (mPas)		400	100	100
Media Temperature (°C) With Specified Dosing Head	PVC	0 to 40		
	Stainless Steel	-10 to 70		
	PP	0 to 40		
	PVDF	-10 to 60		
Ambient Temperature (°C)		0 to 40		
Storage Temperature (°C)		-20 to 50		

Electrical Data	DMX	16-12	35-10	50-10
Voltage (V)		100-240V, 50-60Hz		
Max. Power Consumption (kW) (50Hz)		0.09		
Max. Power Consumption (kW) (100Hz)		0.09		0.18
Enclosure Class		IP65		

Pump Weights	DMX	16-12	35-10	50-10
Plastic Head (kg)		5		
Stainless Steel Head (kg)		7		

Sound	DMX	16-12	35-10	50-10
Max. Sound Pressure Level (dBA)		55		

Approvals	DMX	16-12	35-10	50-10
		CE, EAC, CNROHSEX		

## Ordering

Astles Control Systems are distributors for the entire range of Grundfos dosing pumps. Please send us an email or give us a call with your application details. We will be able to advise the best pump for your application together with price and delivery information.

Email: [sales@Astles.co.uk](mailto:sales@Astles.co.uk)

Phone: +44 (0)1844 273301

